

Ground Water Issue in Montara Around Birch and Cedar Street

San Francisco | Bay-Area
California USA
contact@pmckm.com
+ 1 (415) 316 9029
+ 1 (415) 215-8410

Düsseldorf | Rhine-Ruhr Region
Germany
germany@pmckm.com
+49 (0) 211 170 99033

Belo Horizonte | Minas Gerais
Brazil
brazil@pmckm.com
+55 31 996 34 8421

US Office Address:
100 Parnassus Rd
Berkeley, CA 94708

Registration/Licenses:
California Architects Board
(California USA) C-38791

AKNW Architektenkammer
Nordrhein-Westfalen
(Germany + EU) Architekt A34968

CAU - Conselho de
Arquitetura e Urbanismo
(Brazil) Arquiteto A57642-5

AIA American Institute of Architects
International Associate
#39241078 (Mark Mueckenheim)
#39269768 (Maria Paz)

Corporation Number: C4712309
Tax ID (EIN): 86-2773066



Site Location



Birch Street

Cedar Street

Current Easements
Existing 10x10' corner easement on Birch Street lot
Existing easement on 1234 Cedar Street (Christy Usher) towards Cedar Street Street gutter and then to Mon-

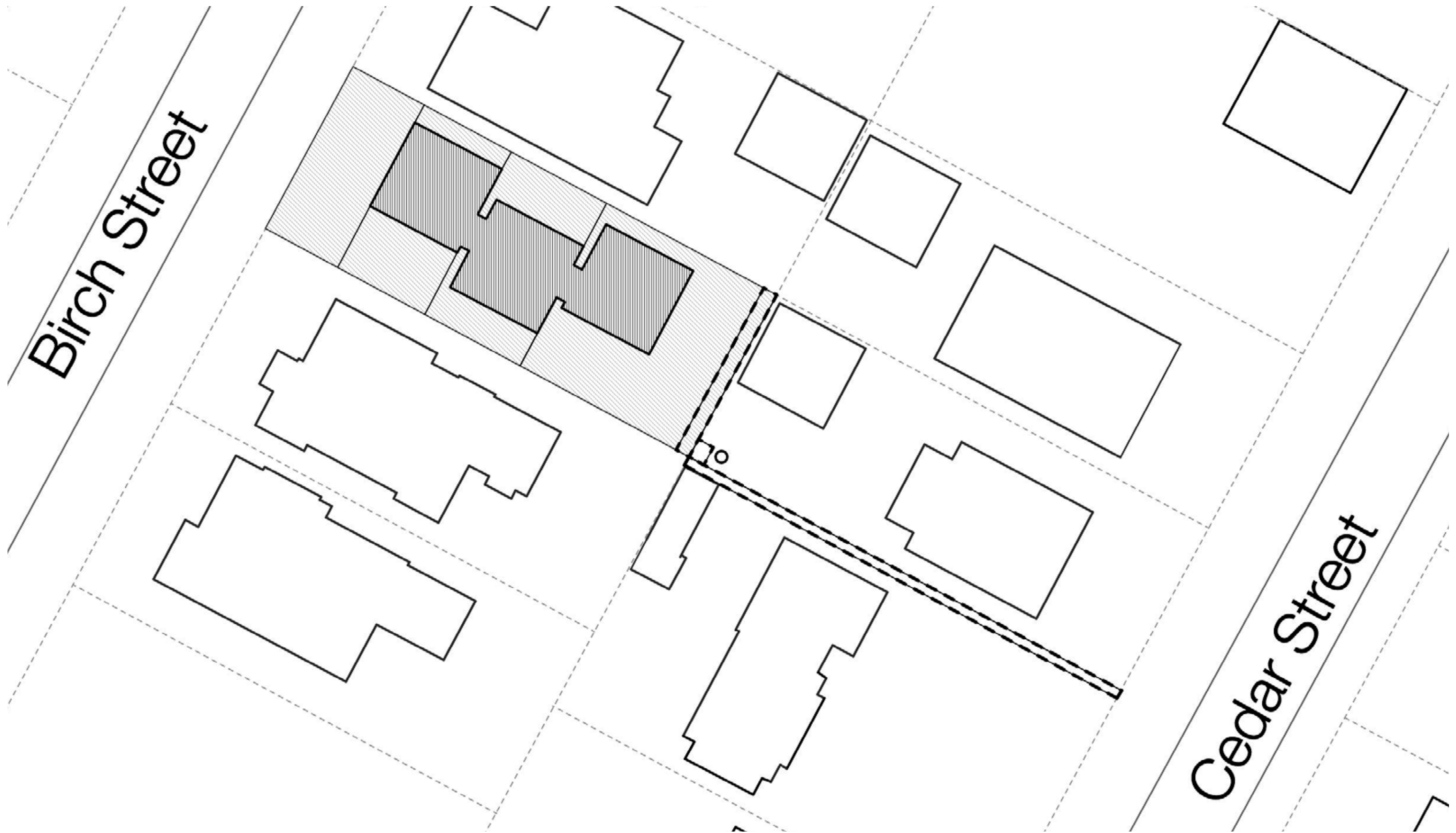

Birch Street

Cedar Street

Proposed Easements
Proposed new Easement on Birch Street lot 3-4' alongside Eastern lot line for a perimeter sub-drain to go out to
Proposed new easement on 1256 (Karen Wilson) Cedar Street towards Cedar Street Street gutter and then to Montara Creek