



County of San Mateo
Department of Public Works

**La Honda Community
Water System
(County Service Area No. 7)**

***Public Meeting Regarding
Drought and Water Conservation***

August 26, 2014

7:00 PM

La Honda Fire Station



County of San Mateo
Department of Public Works

Agenda

1. Overview of CSA 7 Water System
2. CSA 7 Structure
3. Impact of Drought
4. Financial Impact of Hauling Water
5. State Adopted Regulations – Water Conservation
6. Questions and Comments



County of San Mateo Department of Public Works

➤ CSA 7 Service Area and Boundaries:

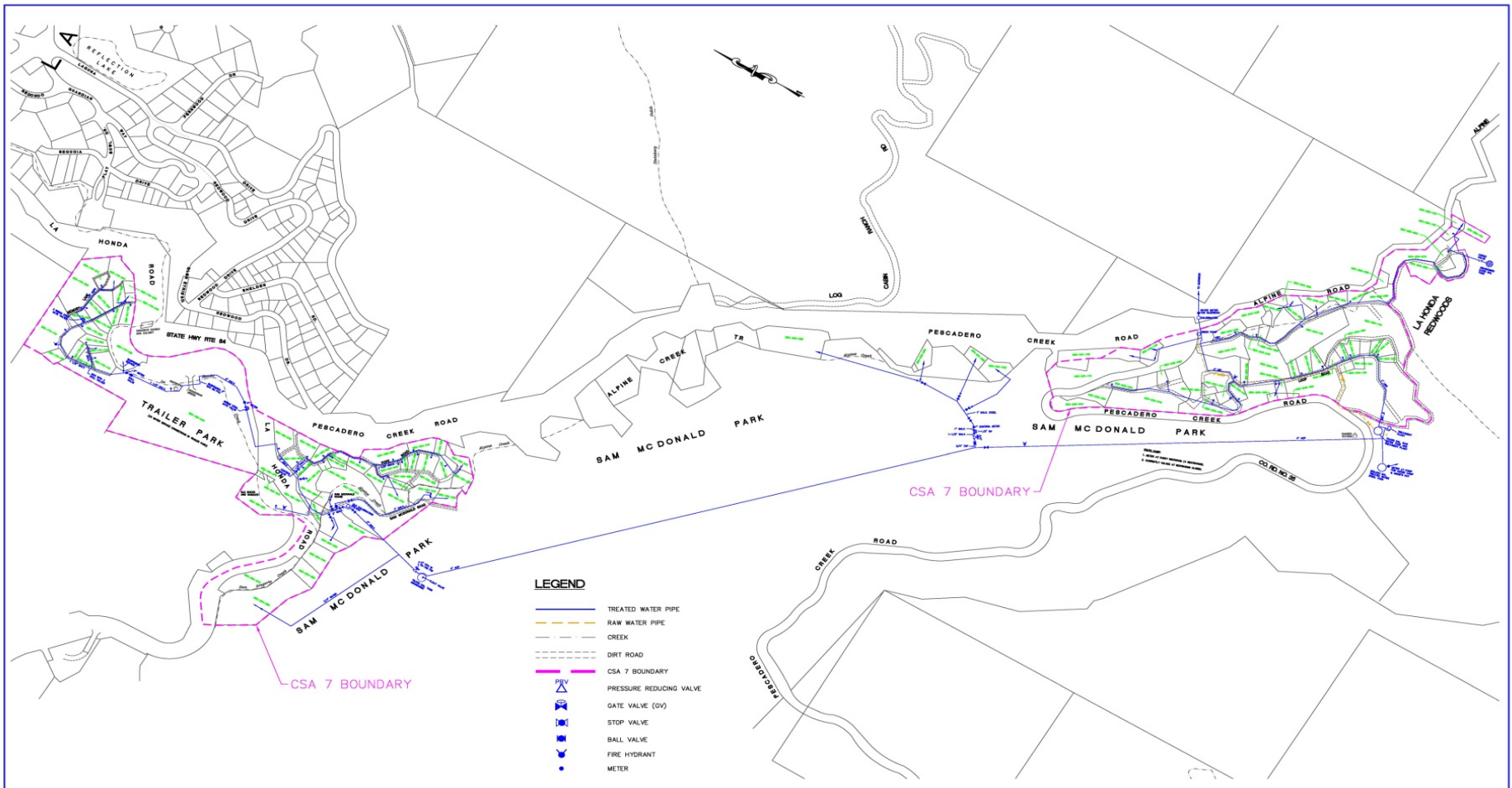

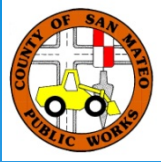

County of San Mateo
Department of Public Works

1. Overview of CSA 7 Water System

- CSA 7 provides water to:
 - 69 residential customers (billing accounts) within CSA 7 boundaries (75% Usage – 6 year average)
 - Sam McDonald Park (5% Usage)
 - Camp Glenwood Boys Ranch (20% Usage)
- Source of revenue:
 - Meter service and water usage charges to residential customers
- Camp Glenwood shares 50% of treatment plant operation & water supply source related costs
- Sam McDonald Park allowed placement of transmission lines through park property and provides staff to assist water main repairs when needed



County of San Mateo
Department of Public Works

1. Overview of CSA 7 Water System

➤ Facilities:

- Intake pump at Alpine Creek water source – vulnerable to weather conditions and contamination
- Water Treatment Plant (WTP)
- 70,000 gallon raw water storage tank (approx. 4 days of water supply)
- 500,000 gallon treated water storage tank (approx. 30 days of water supply)
- 13,000 feet of distribution pipe system (1-4 inches in diameter)
- Pipe Material: Asbestos cement, galvanized, plastic
- Service laterals and meter boxes
- Wharf hydrants

Water System Facts:

- System installed in 1920's to serve vacation homes
- County acquired the system in conjunction with acquisition of Sam McDonald Park in 1958
- Now serving primarily year round residents

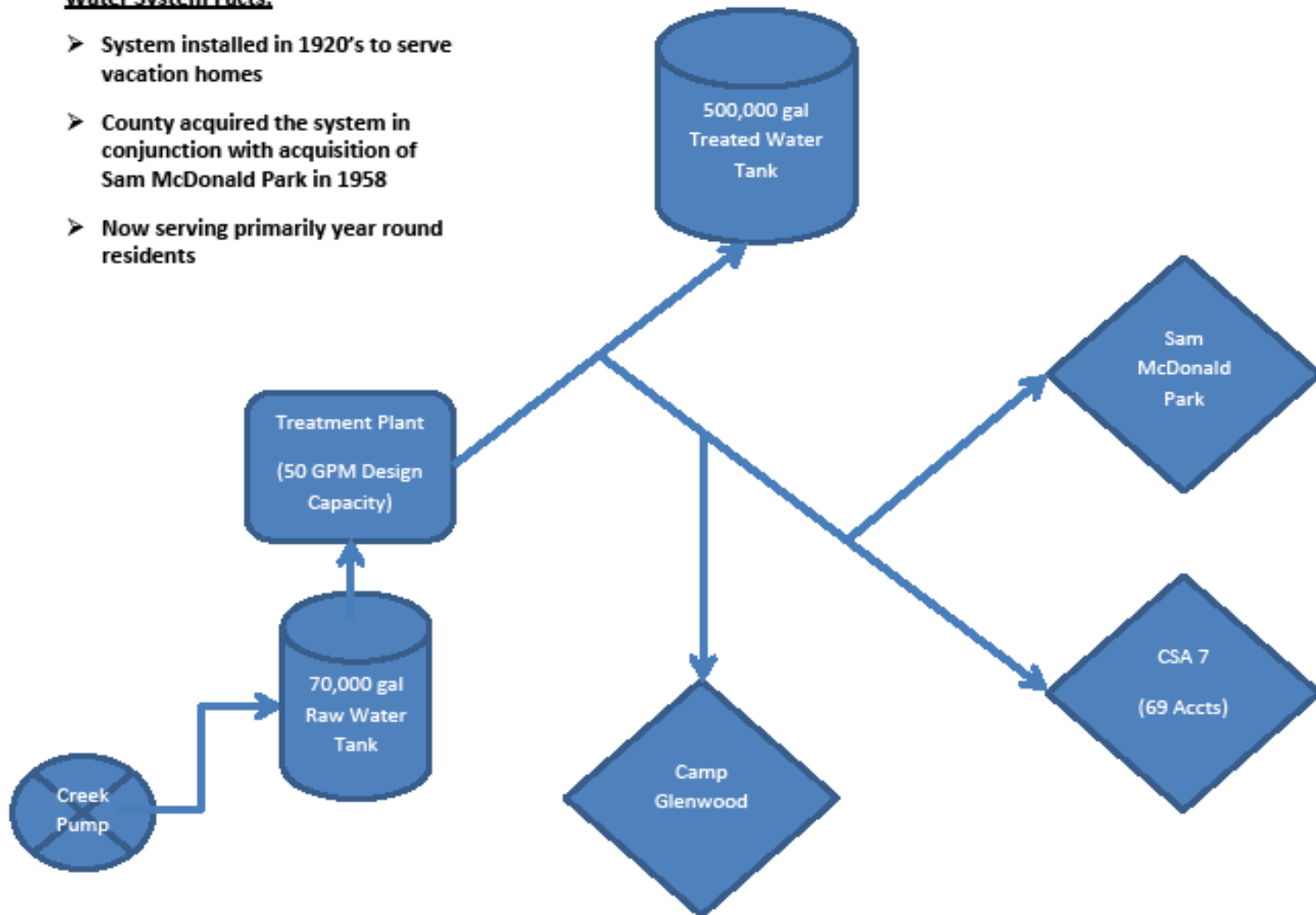

CSA 7 Water System Schematic



County of San Mateo
Department of Public Works

Water Quality and Operations Standards

- Permit for diversion and use of water
 - Issued by the California Dept. of Water Resources Control Board
 - Maximum permitted diversion rate from Alpine Creek is approx. 15 gallons per minute or 22,600 gal/day
- Domestic Water Supply Permit
 - Current permit was issued by the California Dept. of Public Health in 2013
 - To be renewed every 10 years

CSA-7 Expenditure and Reserve Usage Summary
Actuals (FY 2011-12, 2012-13, 2013-14) &
Projected (FY 2014-15, 2015-16, 2016-17)

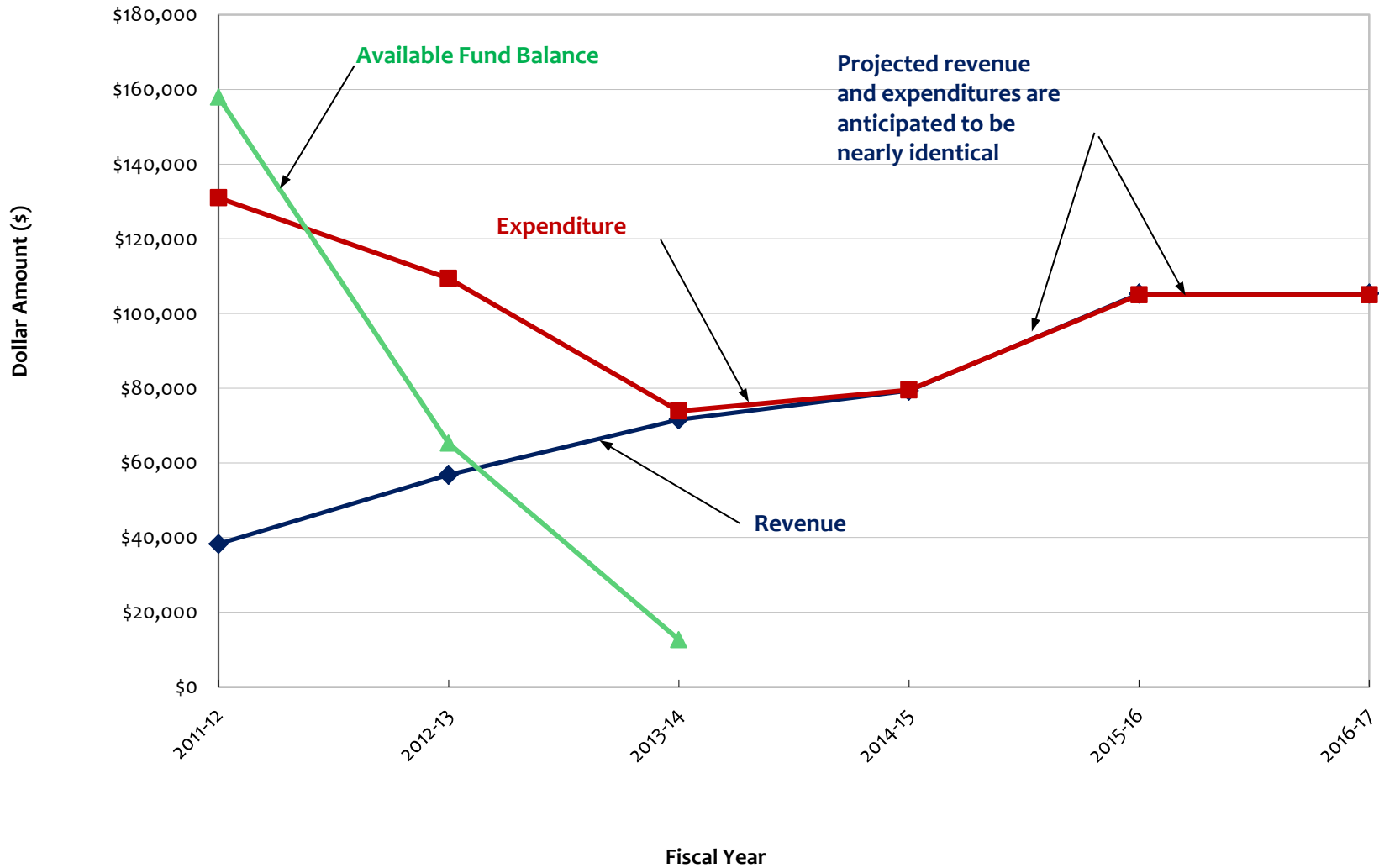



2. CSA 7 Structure

- Administration, Operation, and Maintenance of CSA 7:
 - County Board of Supervisors is the governing body.
 - Department of Public Works provides staff and contractors for operation, maintenance and administration.
 - ❖ Operator (Bracewell Engineering) - Responsible for operating and maintaining system; must be State certified



3. Impact of Drought

- January 2014 – Notified County OES CSA 7 would be impacted if Alpine Creek becomes dry due to the drought. Notified customers to conserve – 1st conservation notice.
- March 2014 – Operator began monthly monitoring of Alpine Creek flow level.
- June 4, 2014 – Alpine Creek flow level at 5” above intake. County OES began weekly incident reporting to State OES.
- June 6, 2014 – 2nd conservation notice to customers.
- June 11, 2014 – Intake pipe was lowered approx. 8” (flow level 13” above intake pipe). Operator began weekly monitoring of creek flow level (varies from 10”-11.5”).
- Creek level of 3” or less above intake requires pumping to stop to prevent damage to the pump equipment.



County of San Mateo Department of Public Works

Pictures showing intake pipe lowered on 6/11/14.





3. Impact of Drought

- Sam McDonald Park
 - No group camping
 - Horse Camp
 - has closed showers (for people)
 - has prohibited washing of horses
 - requires all reservations (RV, trailers) to bring their own supply of water
 - has trucked in water to fill the tank
- Camp Glenwood Boys Ranch
 - Provided water conservation notices (Jan. and June)



3. Impact of Drought

➤ Contingency Plan Development:

- Determine water source(s) for hauling.
 1. Cuesta La Honda Guild (Request declined)
 2. California Water Service Company (Request approved)
 3. City of Palo Alto (Awaiting City Council decision)
- Identify availability and appropriate equipment and staff for hauling
 1. DPW tanker trucks (2-3,000 gal & 1-1,000 gal)
 2. DPW drivers
- Determine cost estimates and funding sources
- Determine triggers for water hauling.



3. Impact of Drought

➤ Contingency Plan:

- When creek flow level reaches **5" above intake pipe**:
 1. Daily monitoring of creek flow level (may request community assistance with monitoring to reduce cost)
 2. Notify stakeholders (CDPH, County EHS, OES, Watermaster) of daily monitoring
 3. Notify DPW Road Division for potential hauling
 4. Notify water supplier with tentative date to begin hauling water



3. Impact of Drought

➤ Contingency Plan:

- When creek flow level reaches close to **3” above intake pipe with greater than 10-day storage:**
 1. Pumping from creek will stop
 2. Update stakeholders (CDPH, County EHS, OES, Watermaster) of status
 3. Board of Supervisors/County Manager to issue Proclamation of Emergency
 4. Coordinate with water supplier, CSA 7 operator, and DPW Road Division to begin hauling water on date specific
 5. Coordinate with County Manager Office to secure emergency funding and additional material/supplies



3. Impact of Drought

➤ Contingency Plan:

- When creek flow level remains **less than 3” above intake pipe with 10-day storage**:
 1. Notify stakeholders (CDPH, County EHS, OES, Watermaster) of the decision to begin hauling
 2. Provide 24-hour notice to water supplier to begin hauling water at filling site
 3. Mobilize CSA 7 operator and DPW Road Division drivers/equipment to begin hauling water to fill raw water tank (approx. 14,000 gallons/day)
 4. Continue daily water hauling for as long as necessary
 5. Report to water supplier weekly hauling amount



County of San Mateo
Department of Public Works

4. Financial Impact of Hauling Water

- DPW drivers and equipment – \$2,000 / day
- CSA 7 operator additional work (not included in contract) – \$500 / day
- Total cost for hauling water range from \$40,000 per month to \$200,000 for five months (Sept. 2014 to Jan. 2015)
- CSA 7 does not have funds to pay for hauling water. Revenue only sufficient to support routine operation and maintenance.



4. Financial Impact of Hauling Water

- Potential Funding Sources:
 - County General Fund Loan
 - State Public Water System Drought Emergency Response Program Grant – Request submitted for up to \$185,400 dependent upon funding availability and on a reimbursable basis only
 - Other Federal or State emergency aid – If available through Proclamation of Emergency - to be determined



5. State Adopted Regulations – Water Conservation Effective 7/29/2014

Regulations applicable to all Californians:

-	Application of potable water to any driveway or sidewalk.
-	Using potable water to water outdoor landscapes in a manner that causes runoff to adjacent property, non-irrigated areas, private or public walkways, roadways, parking lots or structures.
-	Using a hose that dispenses potable water to wash a motor vehicle, unless the hose is fitted with a shut-off nozzle.
-	Using potable water in a fountain or decorative water feature, unless the water is recirculated.

***** The taking of any action prohibited above, in addition to any other applicable civil or criminal penalties, is an infraction, punishable by a fine of up to \$500 for each day in which the violation occurs. *****



5. State Adopted Regulations – Water Conservation Effective 7/29/2014

Mandatory actions by small water suppliers (CSA 7)

Take one or more of the following actions:

-	Limit outdoor irrigation of ornamental landscapes or turf with potable water to no more than 2 days per week; or
-	Implement another mandatory conservation measure or measures intended to achieve a comparable reduction in water consumption relative to the amount consumed in 2013.

For more
information

http://www.swrcb.ca.gov/waterrights/water_issues/programs/drought/emergency_regulations_waterconservation.shtml

Link also posted on the Department of Public Works' web page under "Information for Residents", "Utilities", "Water Services".

CSA-7 3-Year Water Usage Summary (From Quarterly Meter Readings)

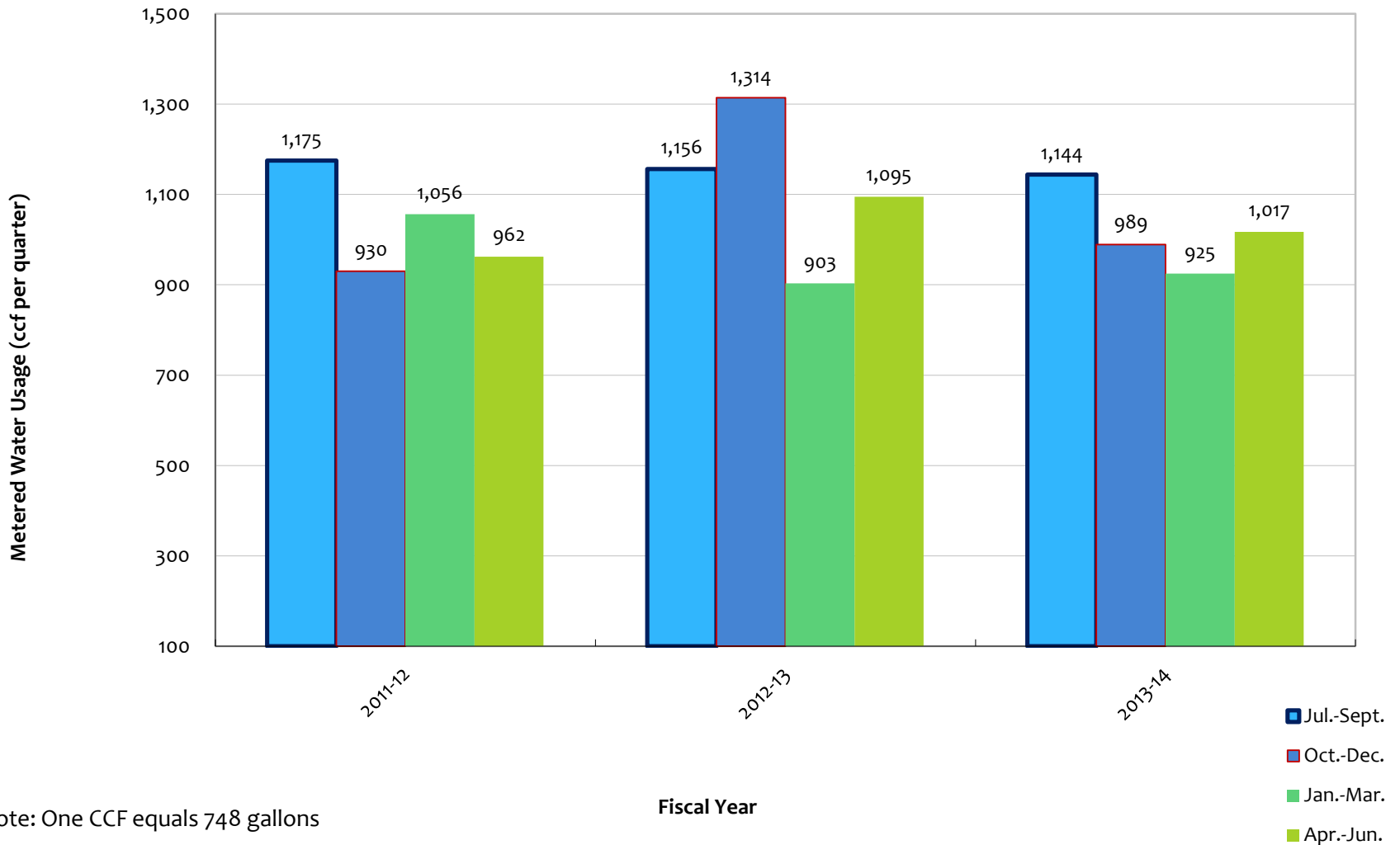

Note: One CCF equals 748 gallons



County of San Mateo
Department of Public Works

Questions and Comments

Thank You!